

Product Information

Modular Fitting System for Valves with Internal Bores DN 10/13



A. u. K. Müller

Solenoid valves
Control valves
Special valves and systems

A. u. K. Müller GmbH & Co. KG
Dresdener Str. 162
D-40595 Düsseldorf/Germany

Tel.: +49(0)211-7391-0
Fax: +49(0)211-7391-281

e-mail: info@akmueller.de
Internet: www.akmueller.de

Series 11.000



Characteristics

- Assembly possible without tools
- Anti-twist protection
- Suitable for warm water up to 65° C
- Connection system up to 10 bar
- High operating safety by the use of high quality materials
- Low noise emission

Description

The 11.000 series Modular Fitting System uses the popular John Guest push fit cartridge for 15 and 18 mm OD tubing. Combined with solenoid valves of 10 and 13 mm nominal bore, it is easily possible to create complex fluid delivery systems. The wide variety of available components makes it applicable to many tasks.

Sealing between the components is provided by the John Guest push fit cartridges, which ensure simple leak free connections without the need for any additional sealing material. This allows easy assembly either during production or on site without tools.

There are a variety of threaded connectors available, including male, female, plastic and brass versions, that allow the modular system to connect to other items. The interlocking teeth on the fittings prevent twisting and make it difficult to tamper with the assembly.

To link with this system, we can provide a large range of solenoid valves. These include servo-controlled and direct acting versions. They are simple to connect and immediately ready for use. Due to its simplified interlocking they can be changed for service purposes using appropriate tools.

Applications

- Steam appliances
- Dental appliances
- Dialysis equipment
- Vending machines
- Industrial appliances
- Sanitary
- Air conditioning
- Cleaning systems
- Temperature equalizers
- Dish washers
- Washing machines
- Water treatment
- Whirl systems for bath tubs
- Car washes





Series II.000

L-couplings

part no.	picture	drawing
007249		
007252		

Materials	
Housing	POM
John Guest cartridge	POM
Sealings	EPDM

X-couplings

part no.	picture	drawing
007250		
007253		

T-couplings

part no.	picture	drawing
007248		
007251		
-		



Internal bore of coupling	John Guest cartridge Ø
DN 10	15
DN 13	18

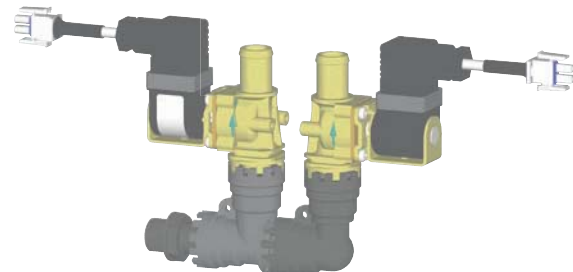









Series 11.000

Valve housings ...

...for pre-assembled servo controlled valves of model range 01.010.126, 01.013.126 or direct activated valves of model range 01.010.127, 24.006.126

Designed for John Guest cartridge Ø	DN / mm (valve seat)	part no. (valve housing)	picture	connection
15	10	on request		straight valve housing JG-Adapter - JG-Adapter
15	10	007319		straight valve housing JG-Adapter - G 3/4
15	10	007310		straight valve housing G 3/4 - JG-Adapter
18	13	on request		straight valve housing JG-Adapter - JG-Adapter
18	13	007348		straight valve housing JG-Adapter - G 3/4
18	13	007366		straight valve housing G 3/4 - JG-Adapter



Series II.000

Threaded connections

part no.	picture	drawing
007256		
007320		
007257		
007322		
007326		

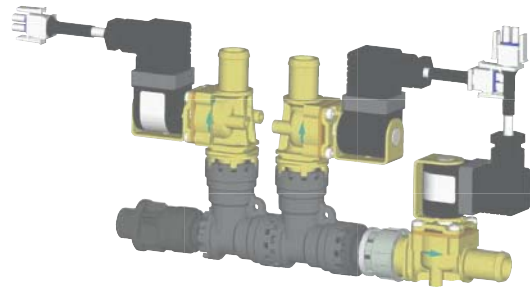
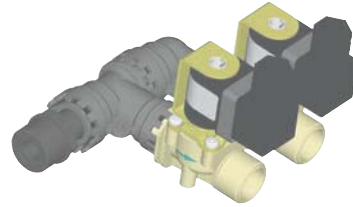

Sealing plug

part no.	picture	drawing
007254		
007255		

Threaded connection sockets - John Guest Adapter

part no.	picture	drawing
007323		
007324		